

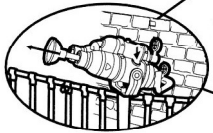

PLUNGER GUN BLASTER:

1. First, mount Plunger Gun Blaster onto balcony railing as shown.
2. Then load both Plunger missiles into the Plunger Gun Blaster as shown until they click in place.

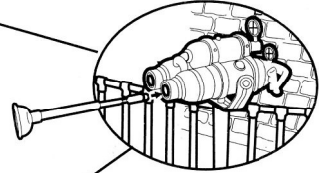

3. Press the 2 buttons on each side of the Plunger Gun Blaster to fire Plungers. The Plunger Gun Blaster is adjustable on it's frame.



SEWER ELEVATOR:
The Sewer Elevator is operated by a lever on the back of the Center Lair Section. Move the lever up to make the elevator move upwards.

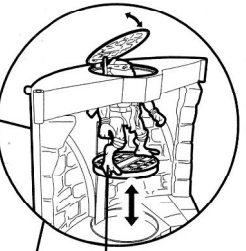

Place the figure onto the elevator platform as shown, using the footpegs to secure the figure in place.



When moving the elevator upwards the figure's head will open the manhole cover as shown.

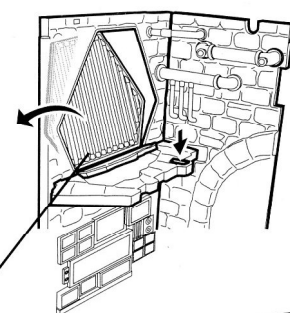

TRAP DOOR:

1. To operate, first push Barred Wall Section in place until it clicks.
2. Then place a figure next to the trap door.
3. To activate, press the button on the elevated platform as shown. The trap door will pivot backwards, making the figure fall out of the Lair.

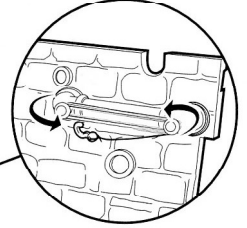

ZIP LINE

1. Unwrap zip line string and hook from Pipe Section on Right Lair Section.

2. Pivot Hook arm outward and to the front of the Subway Car as shown.

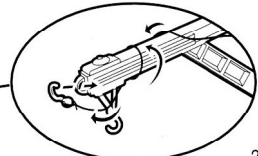

3. Hook zip line string around the Hook arm. Adjust it so that its taut (do not make it too tight!).
4. Take zip line handle and place it on top of zip line as shown. Then attach figure's hands to the handle's grips.
5. Starting at the elevated Pipe Section, let go of the figure and let it slide down the zip line.

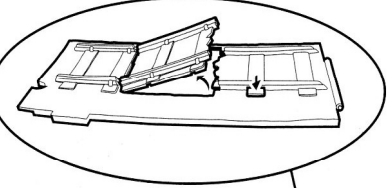
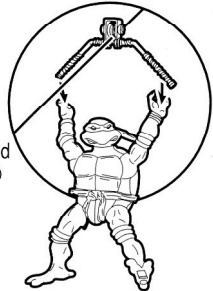

TRACK ATTACK FEATURE:

1. To activate the Track Attack feature, push the Trap Section until it clicks into place.
2. Then place a figure on top of the Track Attack Section. Press the secret attack button to activate the Track Attack Action.

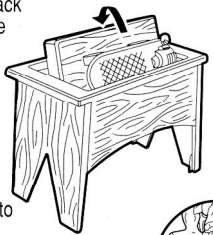

DONATELLO'S FAST-ACTION WORKBENCH:

1. Snap work bench into floor of subway car.
2. Rotate workbench surface so that the skateboard parts are on top. It will click into place.
3. To activate "Fast-Action" reveal, just press the button on the side of the workbench. The platform will turn over, "magically" revealing Donatello's latest Turbo-Skateboard invention!
NOTE: Skateboard is NOT removable from the workbench.

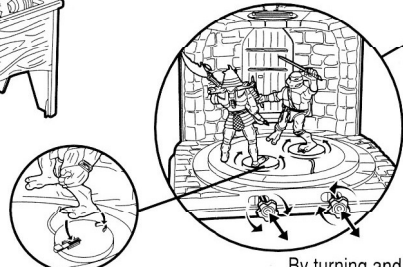

BATTLE/TRAINING ARENA:

1. Attach a figure to each Battle platform by sliding back the Toe-grip Section as show.
2. Then place your figure's foot into place and release the Toe-grip as shown. The gripping action of the Toe-grip will hold the figure into place until you battle your opponent!

By turning and sliding the appropriate Power Rod knob on the front of the Battle Arena, you can control how your figure moves. Place 2 figures on the Battle Arena and battle against each other until one of the figures is knocked off!

SECRET WEAPON RACK:
Snap weapons into the Weapon Rack side of the Secret Wall in the Center Lair Section as shown.

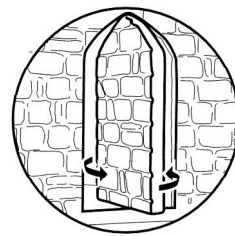
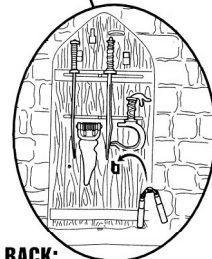

Once you have all the weapon in place on the rack, spin it around to hide them. When you want to use the weapons, just push on the door and it will turn around, revealing the Secret Weapons Rack.

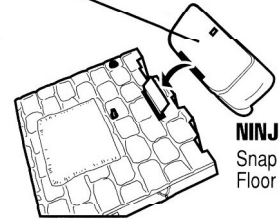

NINJA ACTION SOFA:
Snap Sofa into Right Lair Floor Section as shown.

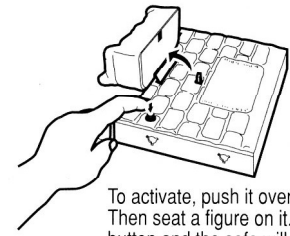

To activate, push it over to lock it in place. Then seat a figure on it. Press the activation button and the sofa will snap back and flip over the figure.